

## Mode Field Adapter

<b>Features</b>	
Low Insertion Loss High power handling capability. Excellent Stability.	
<b>Application</b>	
Fiber Laser High Power Fiber Amplifier	

### Specifications

Input Fiber	Output Fiber	Working Wavelength (nm)	Insertion Loss (dB)	Power (W)
A/125 SC or DC	B/125 SC or DC B/250 DC B/300 DC	1020-1080	0.3~0.5	10-30
PM A/125 SC or DC	PM B/125 SC or DC PM B/250 DC PM B/300 DC	1020-1080	0.5~0.7	10-30
PM8/125 SCF or DCF	PM 25/300 DC	1530-1565	0.3~0.5	10-30

\*A, B means difference fiber core size, fiber core 6um, 8um, 10um, 12um, 15um, 25um, 30um

\*IL and power is depend on exact MFA configuration

\* Forward: Small MFD to large MFD, Backward: Big MFD to small MFD

### Package Dimensions

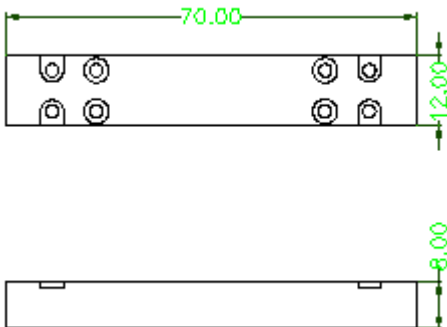

### Ordering Information

MFA	Wavelength	Input Signal Fiber	Output Signal Fiber	Pigtail	length
	1550 1064	Pls write fiber core/Cladding	Pls write fiber core/Cladding	0=bare fiber	0.5=0.5M 0.8=0.8M 1=1m S=Specify